

STAFFORD SITE MAP AND RULES



To keep up to date with the latest news,
follow us on social media!



Central Car Auctions Limited



Central Car Auctions

SITE MAP

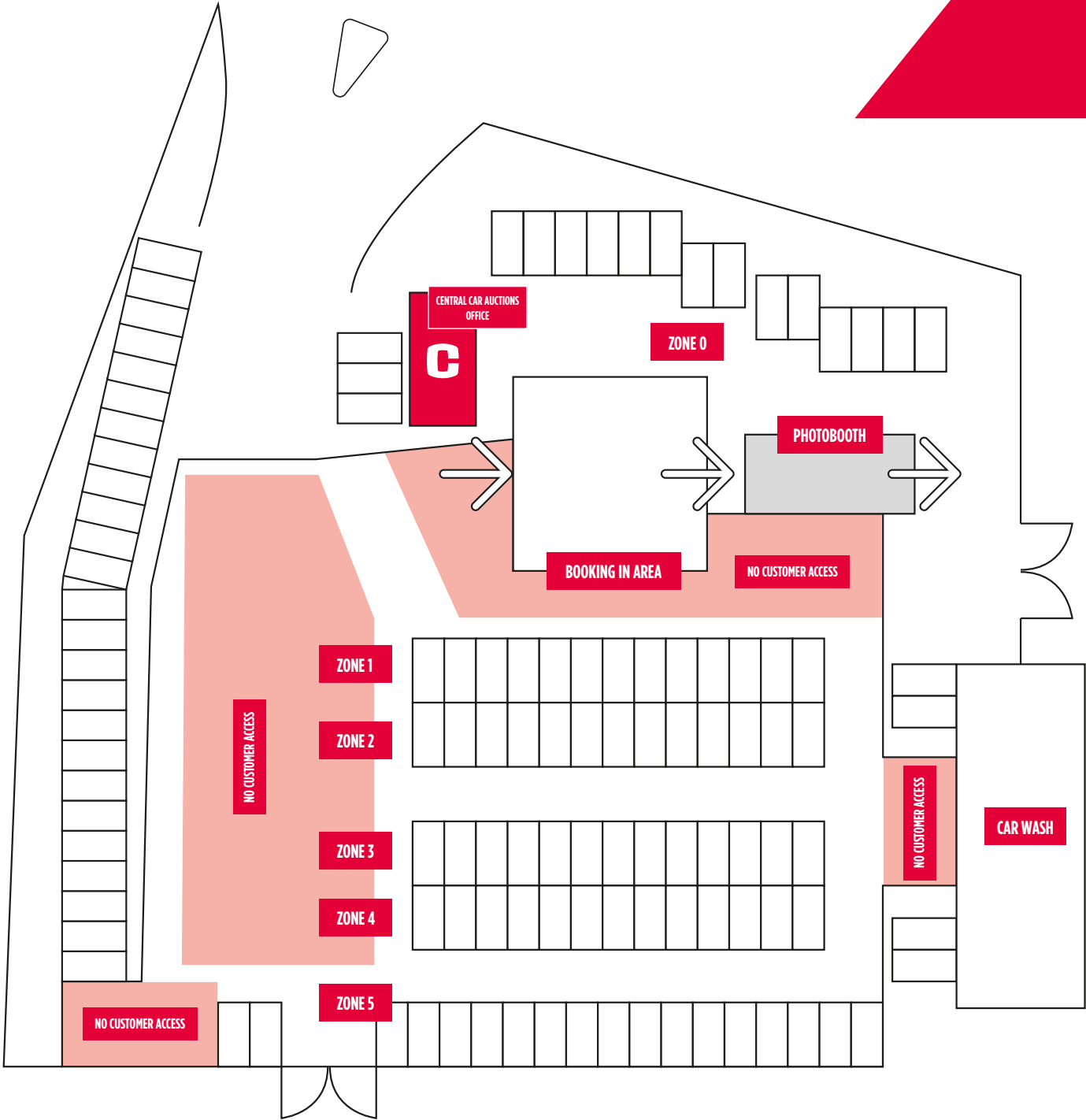

SOLD SECTION

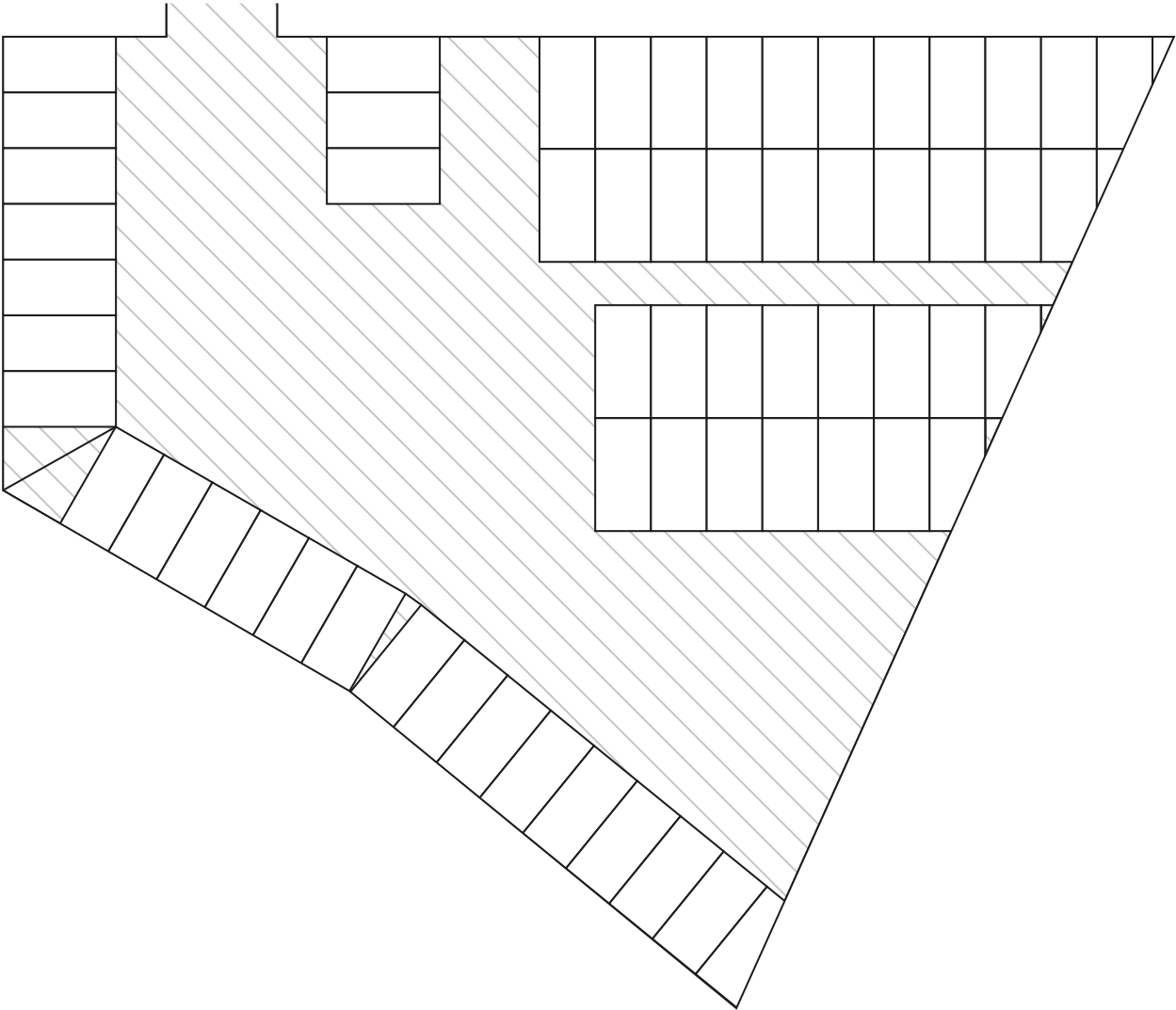



SITE RULES

- Central Car Auctions external vehicle parking is an extremely busy place of work, so please take care when visiting.
- Please be aware of vehicles entering and exiting the display area and photo booth, and of large transporters loading and unloading vehicles.
- A large volume of vehicles passing through our site each week; for your own safety, please be aware of moving vehicles and follow marked traffic routes and pedestrian walkways at all times.
- Vehicles can only be collected during Central Car Auctions opening hours.
- Transporter and trailer collection must be completed outside the compound in the designated loading areas.
- Customer parking is restricted to the designated area adjacent to the main office building
- All customers must report to the Central Car Auction office prior to accessing the vehicle display area.
- Only trade account holders are permitted to access the site.
- Please do not enter any prohibited access areas.
- All persons under the age of 16 years must be under the direct supervision of an adult at all times.
- Any person under the age of 16 will not be allowed entry if unsupervised or cannot prove their age if asked to do so.
- A maximum speed limit of 5mph is in force throughout the whole site.
- First aid – if you require assistance, please ask a member of the team or report to reception.
- In the event of an accident, please contact a member of staff.
- No dogs are allowed on site except guide dogs.
- In the event of the fire alarm sounding, please make your way to the fire evacuation point, which is clearly identified at the main entrance of the site.
- In the unlikely event of an evacuation, do not stop to collect any personal belongings and do not return to the building until told to do so by the senior person in charge.
- Smoking and vaping are restricted to smoking shelter situated at the rear of the office building.
- If you discover a spill (oil, diesel or petrol), please report this to a member of the team on site.

